

# INSTALLATION GUIDE

## FRONT LOAD SNAP-OPEN ALUMINUM FRAMES MOUNTED TO 10MM ROD SYSTEMS WM11-10 Rod Support Fixing

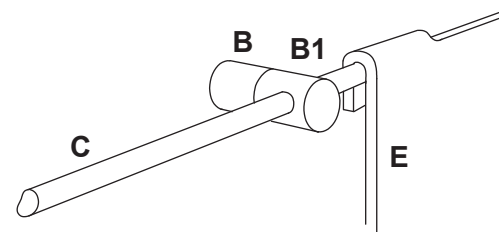
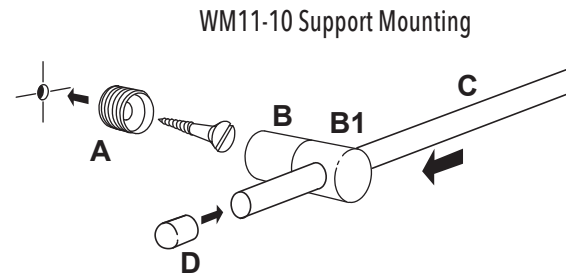
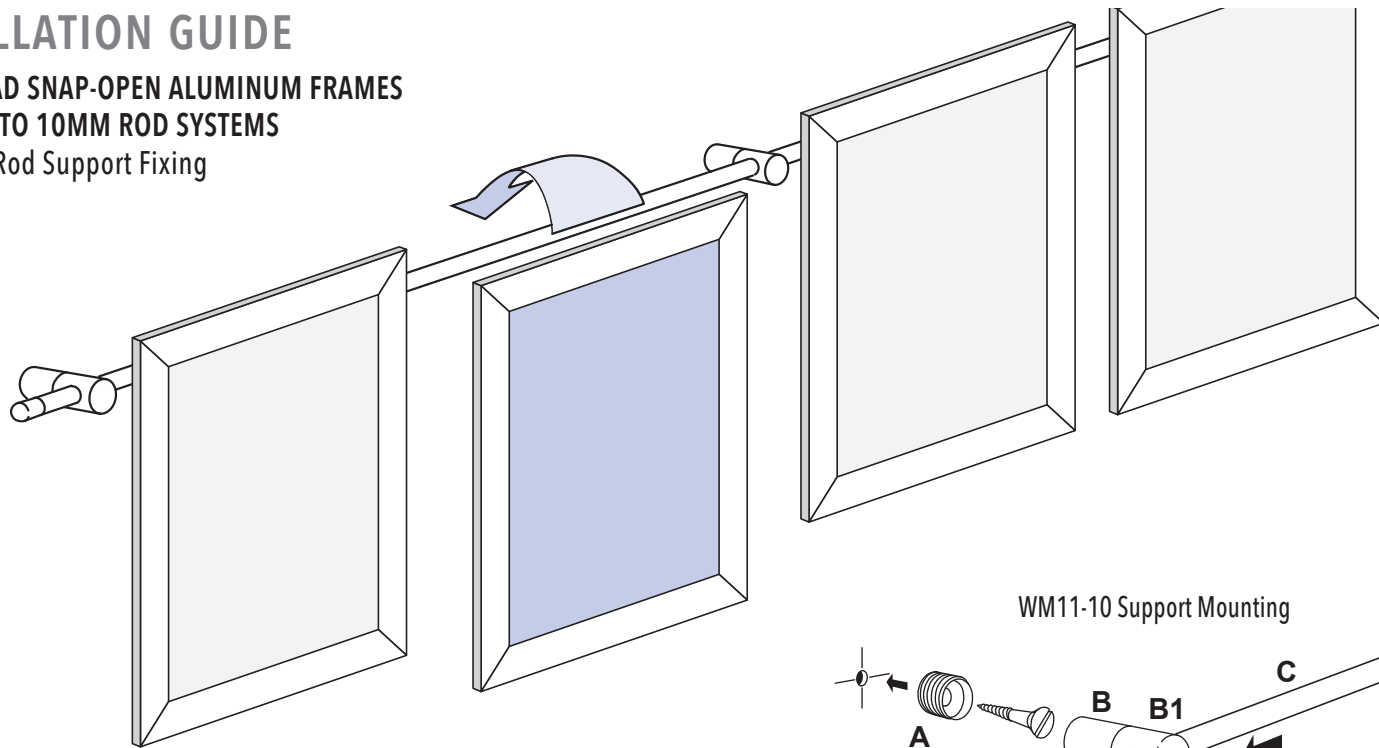

**IMPORTANT:** It is essential to choose the right type of screw for fixing these supports to your wall (see diagrams below).

- 1) Select the first point at which rod is to start. Affix the brass fitting (A) to wall using a suitable fixing depending on the wall type:
  - for wood stud walls use a wood screw.
  - for cavity/plaster wall use a spring toggle bolt or twist-n-lock anchors.
  - for solid/concrete wall use a raw-plug and screw.
- 2) Using a measuring tape and a leveler; mark all fixing points as required in order to fit your acrylic pocket format, or any other hook-on acrylic accessories, and repeat procedure for all brass fittings (A).
- 3) Remove and affix the base part (B) of wall rod supports onto the brass fittings (A).
- 4) Loosen the set screws on the front part of wall supports (B1) and slide them all on the rod (C) at required position. Move the front part (B1) to matching position with (B) base part and attached the rod assembly to wall and then tighten back the set screws with Allen Key provided. Rod needs to be cut to size before attaching to the wall.
- 5) Attach the decorative end cap (D) to both ends of rod.
- 6) Attach your display accessories (E) to the rod.

**NOTE:** For lightweight display components such as small and medium size acrylic frames, acrylic holders, and aluminum frames Nova Display Systems provides twist-n-lock anchors. It is at your discretion to use the anchors provided or use similar product rated for 50 to 75 lb weight limit.

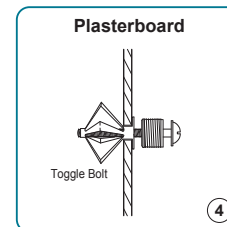
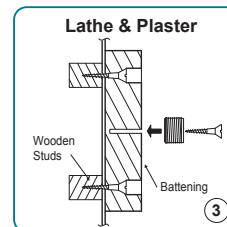
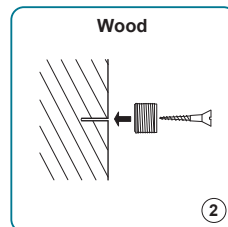
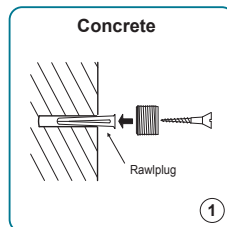

**NOVADISPLAY™**  
INNOVATIVE DISPLAY SOLUTIONS

Nova Display Systems, Inc.  
875 Wilson St., Ste. A-B  
Eugene, OR 97402  
541.505.7450  
541.505.9919 fax  
sales@novadisplaysystems.com  
www.novadisplaysystems.com

### Wall Display Concept

ID: **DC2603**  
**DC2604**

Title: Recognition Wall Display

### Installation Guide

ID: **DC2603-INST**  
**DC2604-INST**

**NOTE:** It is important to check the strength of the wall fixing(s). Nova Display Systems takes no responsibility for incorrect installation. This responsibility relies with the installer.

Note: This drawing is the property of Nova Display Systems and is not to be reproduced or copied in whole or in part. It is only to be used for the project and site specifically identified herein and is not to be used on any other projects, or for the purpose of manufacturing and reproduction. It is to be returned upon request.

Sheet:

Page: 1 of 1

Scale: n/a