

INSTALLATION GUIDE

ACRYLIC EASY ACCESS HOLDERS MOUNTED TO 1.5MM CABLE SYSTEMS / WALL-TO-WALL CWW & CG01 Cable Support Fixings

IMPORTANT: It is essential to check that the top ceiling fixings are strong enough to take the weight of the items being displayed, while allowing for the tension in the cables.

- 1) Select the upper height to which the cable is to start. Affix base fitting (A-B) to wall using a suitable fixing for the wall type:
 - for wood stud walls use a wood screw.
 - for cavity/plaster wall use a **spring toggle bolt** or **twist-n-lock anchors** (for lightweight items only).
 - for solid/concrete wall use a raw-plug and screw.
- 2) Using a plumb line; descend from (A) to the required position for base fitting (G-F), and affix.
- 3) Separate the two sections of part (C) and (E), and loosen the grub screws in the small brass piece (D), using the Allen key provided, and slide fittings up the cable to the desired length. (Do not remove from cable).
- 4) Having selected the required length, tighten the brass fitting and cut off the excess cable.
- 5) Re-connect the two sections (C) and (E), and tighten to adjust tension.

NOTE: For lightweight display components such as small and medium size acrylic frames and holders Nova Display Systems provides twist-n-lock anchors. It is at your discretion to use the anchors provided or use similar product rated for 50 to 75 lb weight limit. It is important to check the strength of the top fixing(s). NOVA DISPLAY SYSTEMS takes no responsibility for incorrect installation. This responsibility rests with the installer. **Cables are not supplied with fixing screws.**

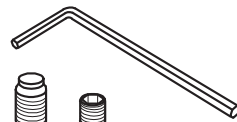
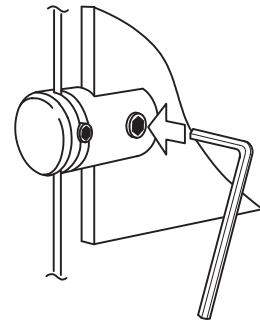
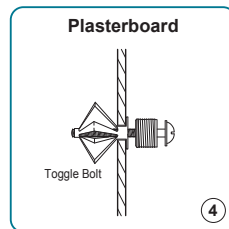
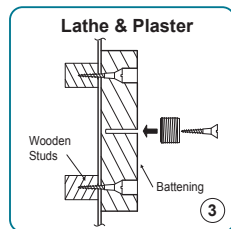
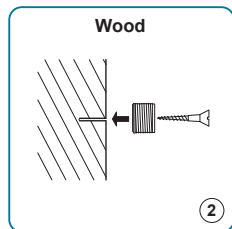
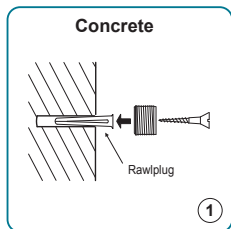

P10 - M6 x 8mm Set Screw w/Teflon Tip
P11 - M4 x 6mm Grub Screw

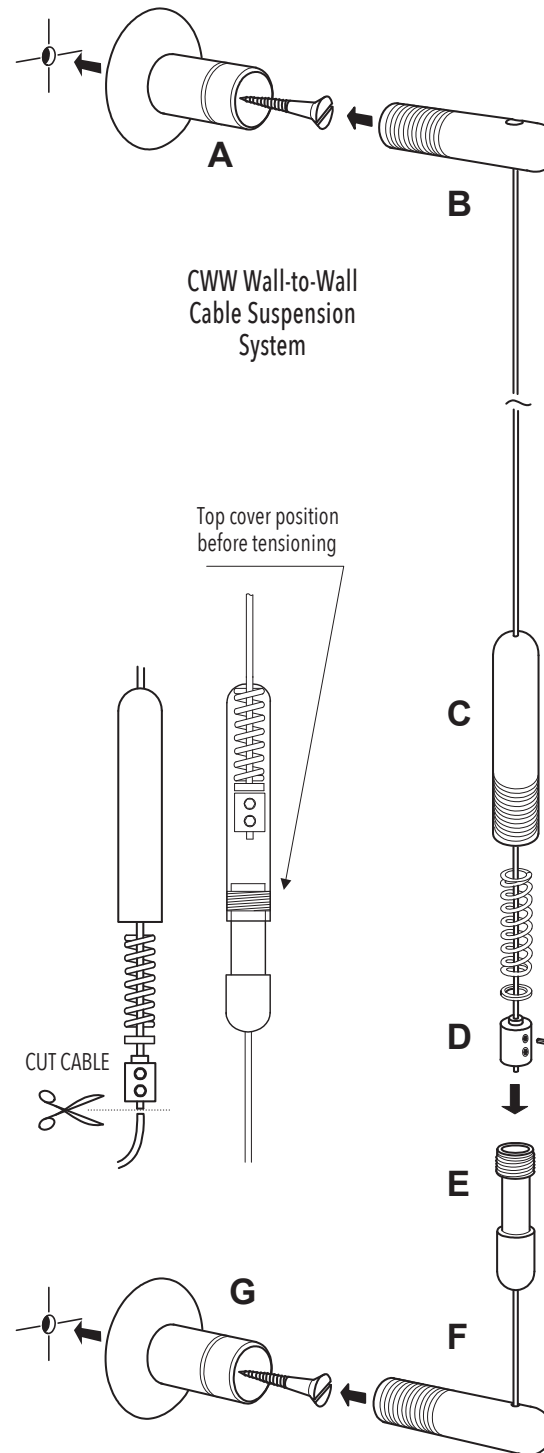

NOVA DISPLAY
INNOVATIVE DISPLAY SOLUTIONS

Nova Display Systems, Inc.
875 Wilson St., Ste. A-B
Eugene, OR 97402
541.505.7450
541.505.9919 fax
sales@novadisplaysystems.com
www.novadisplaysystems.com

Wall Display Concept

ID: DC2300
DC2302
DC2303

Title: Literature Wall Display

Installation Guide

ID: DC2300-INST
DC2302-INST
DC2303-INST

NOTE: It is important to check the strength of the wall fixing(s). Nova Display Systems takes no responsibility for incorrect installation. This responsibility relies with the installer.

Note: This drawing is the property of Nova Display Systems and is not to be reproduced or copied in whole or in part. It is only to be used for the project and site specifically identified herein and is not to be used on any other projects, or for the purpose of manufacturing and reproduction. It is to be returned upon request.

Sheet:

Page: 1 of 1

Scale: n/a