

WALL INSTALL TEMPLATE

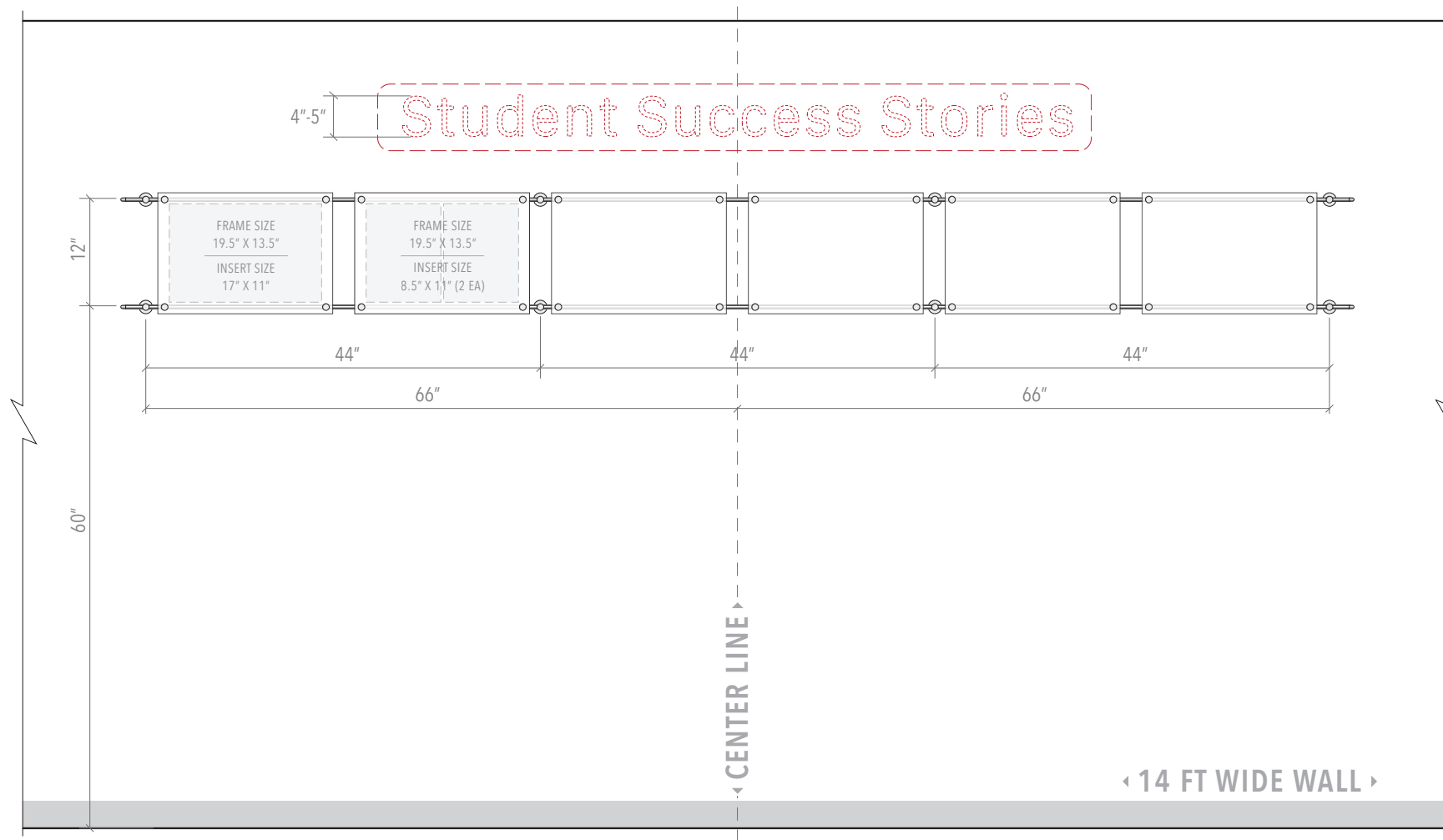

DETAILS:

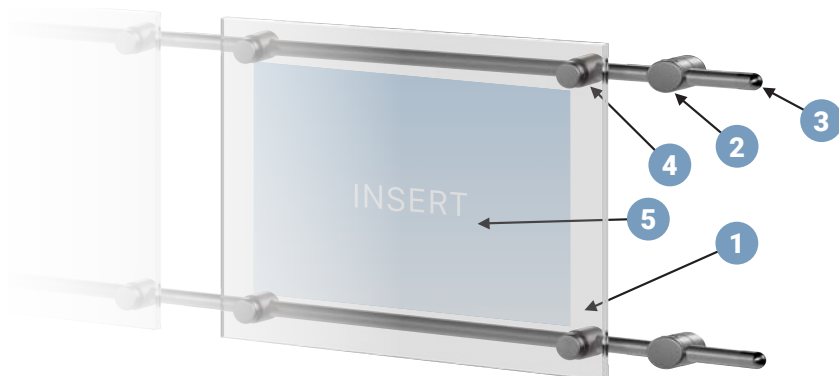

Acrylic Frames for Info/Poster Inserts / Rod Supported

1. Acrylic frames used with horizontal rod system are supplied with "clear" or "non-glare" front. Panels are a 1/8" thick and are drilled for M4 studs.
2. Rods are mounted onto the wall with WM11-10 supports. P01 decorative support plates are optional.
3. Join two of the R1500-10 and one R500-10 rods together to create a 138" long rod. Use REC-10 end caps for rod-end finishing.
4. Use RS13-10 supports to mount the acrylic info/poster frames and acrylic literature holders to rods.
5. Inserts are mounted in between the two pieces of acrylic and fixed in place with low-tack (3MTM 9415PC Removable Repositionable) double sided adhesive tape.

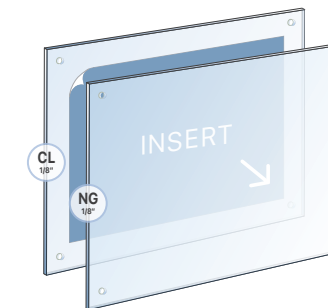
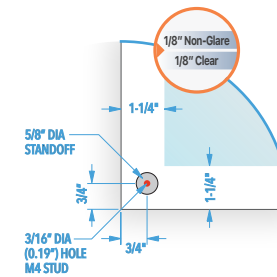

Note: Non-glare (non-reflective) acrylic front cover helps to reduce the glare and provides a mild protection against harmful UV rays.



NOVADISPLAY™
INNOVATIVE DISPLAY SOLUTIONS

Nova Display Systems, Inc.
875 Wilson St., Ste. A-B
Eugene, OR 97402
541.505.7450
541.505.9919 fax
sales@novadisplay.com
www.novadisplaysystems.com

Wall Display Concept

ID: DC2207

Title: Info/Poster Wall Display

Display Size:

14"H x 138"W

Wall Size Requirements:

14 FT (168 IN) Wide

Wall Install Template

ID: DC2207-WT

Note: Dimensions on the drawing display hardware mounting points on the wall. These are suggested dimensions and can be slightly modified to accommodate for your own wall specifics.

Note: This drawing is the property of Nova Display Systems and is not to be reproduced or copied in whole or in part. It is only to be used for the project and site specifically identified herein and is not to be used on any other projects, or for the purpose of manufacturing and reproduction. It is to be returned upon request.

Sheet:

Page: 1 of 1

Scale: n/a